

SUSPENSIONS

Introduction to **Type 03** Single T-Rail Flush Mount

- Quick and easy installation for regular ceilings
- Easy removal for frequently washed applications
- Inexpensive
- Shortest distance between ceiling and duct

Click or Scan

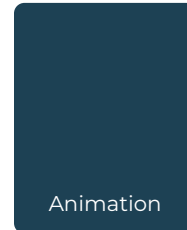

Click or Scan

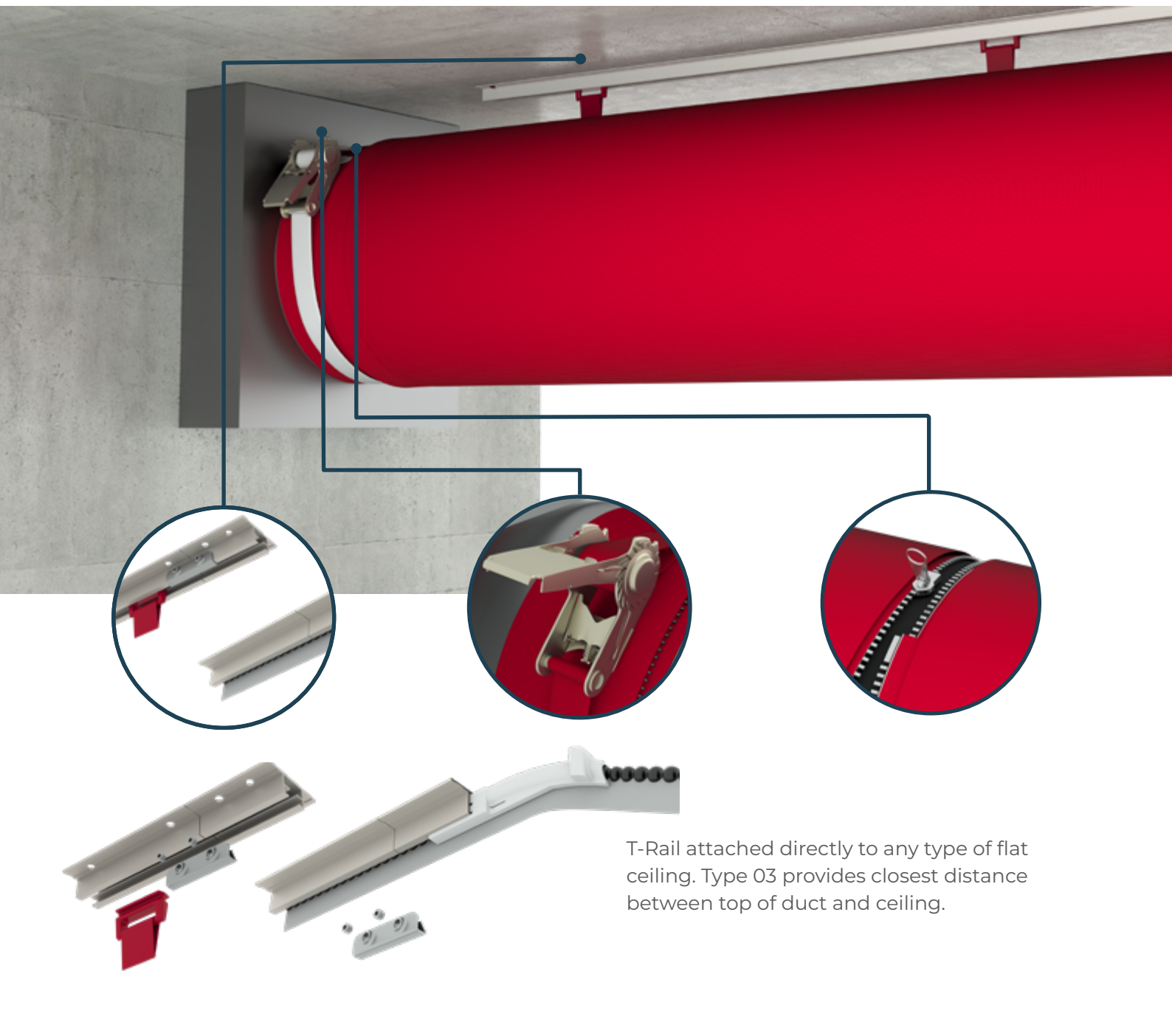
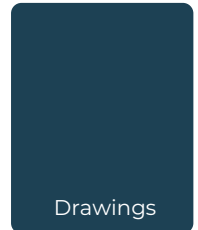

T-Rail attached directly to any type of flat ceiling. Type 03 provides closest distance between top of duct and ceiling.

Example of duct system configuration

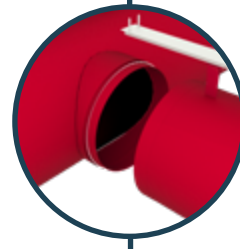
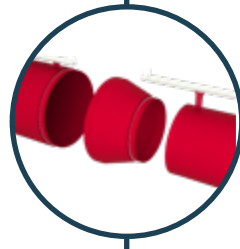
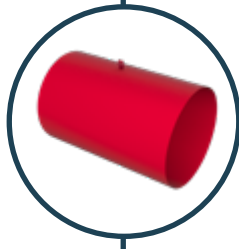
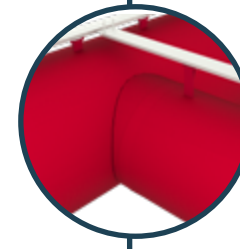
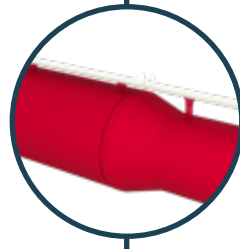
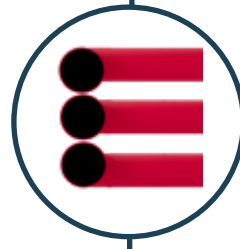
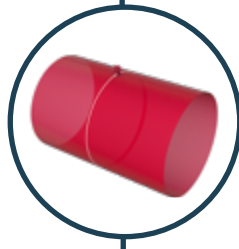
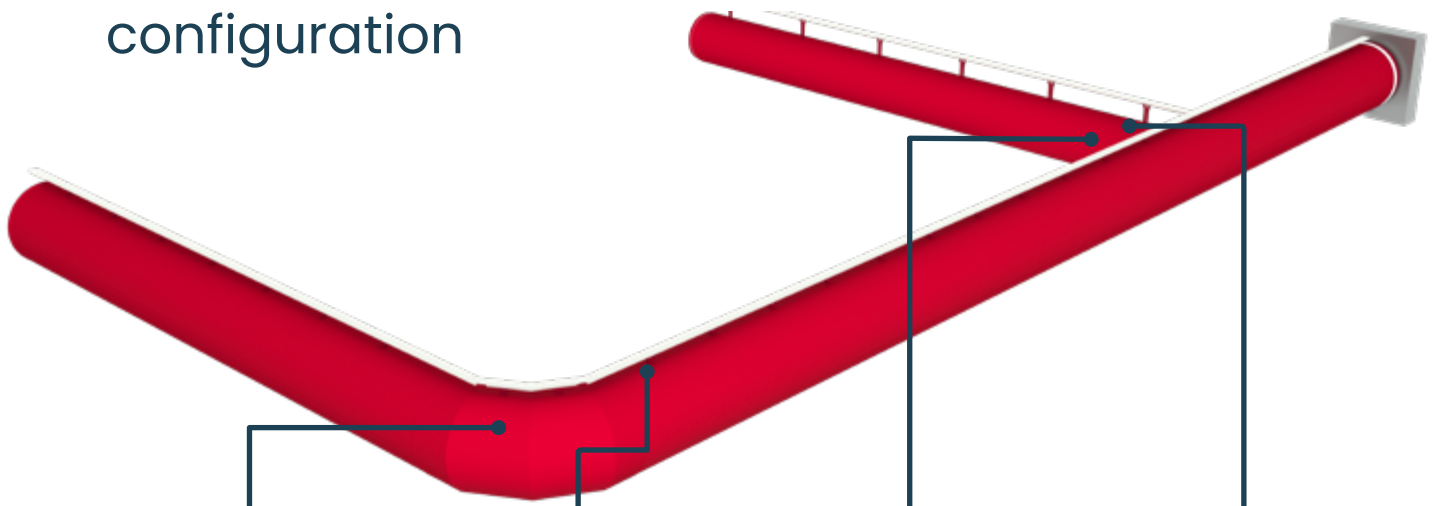

Elbows

We provide custom elbows in any degree and size.

Shape Retention

Our ducts come with your selected Shape Retention solution: All-in-One or Internal 360° Hoops. The 360° hoops are hidden inside the duct whereas All-in-One 180° hoops are sewn on the exterior. Shape retaining hardware is removable for laundering.

Reductions

Concentric and eccentric reducers are available.

Branches

Concentric and eccentric branch take-offs are available.

Options available for **Type 03**

T-RAIL for Type 03

Type 03 used to mount where ceilings are close to floor. T-rail is produced in 2 meter sections using an extrusion process and then anodized, making it an excellent choice for corrosive environments. The duct will have sliders, or a bulb edge, to slide the channel in the T-rail at the appropriate locations for both single and double T-rail configurations.

