

Ceiling Diffuser

Installation Manual for SMI and EPI

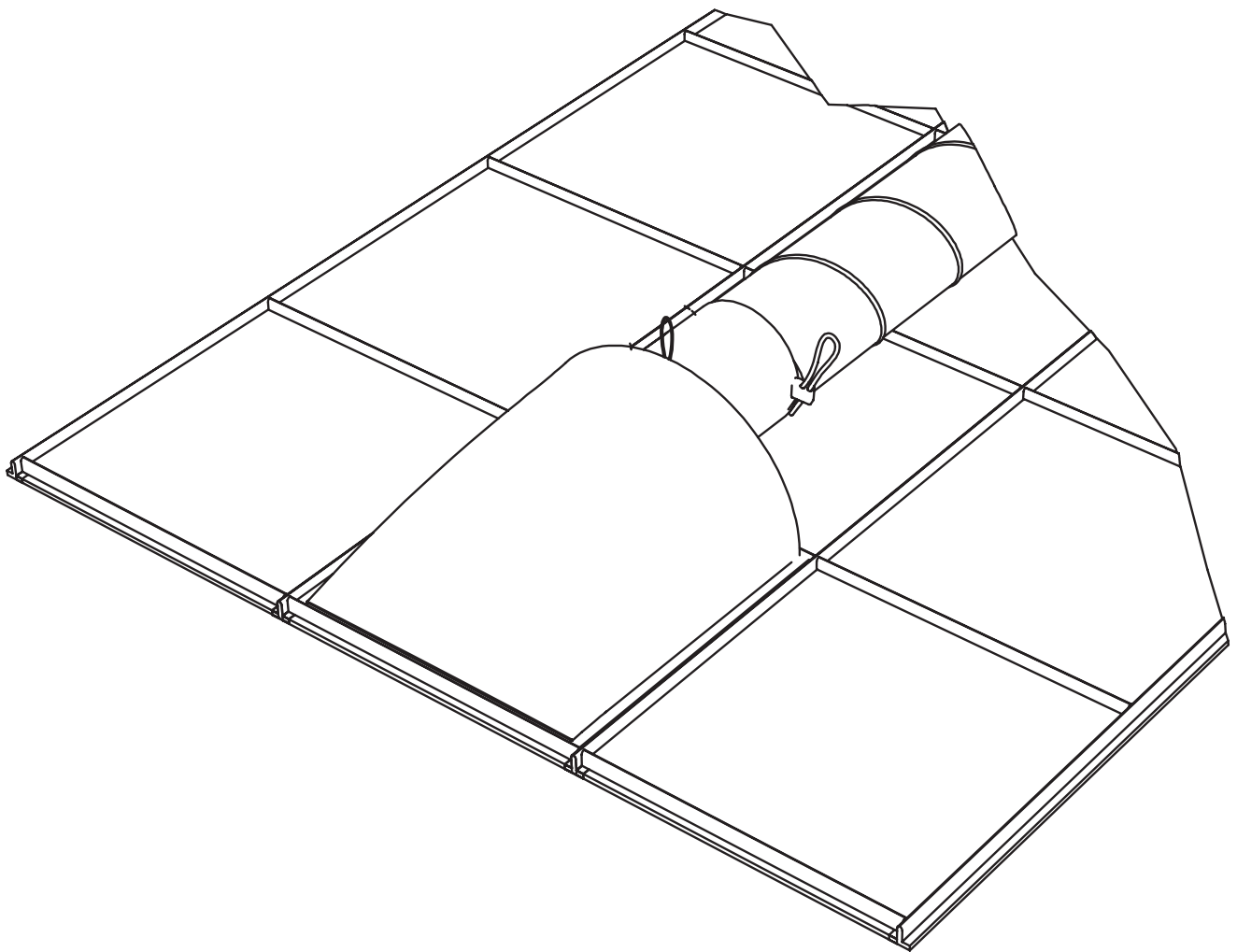

Flow panel mounting

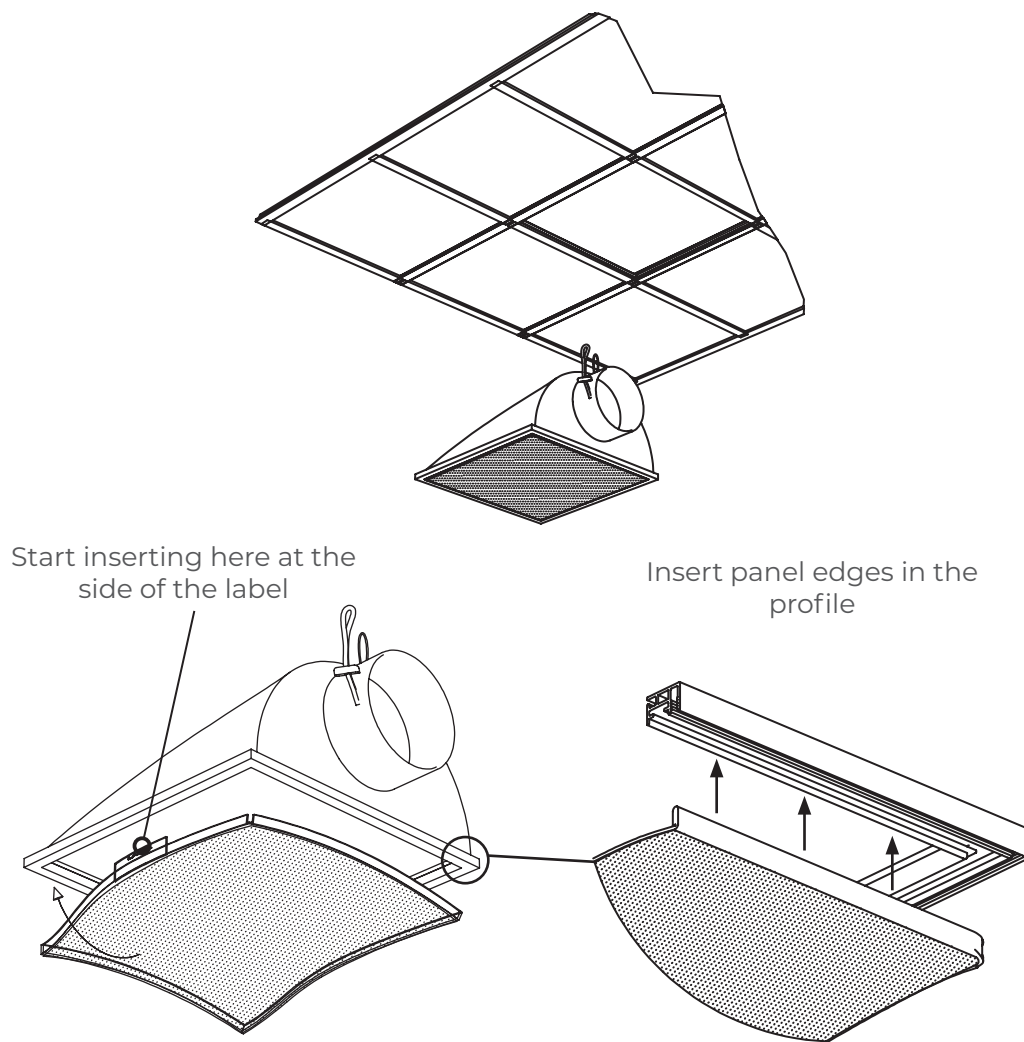

Flow panel dismantling

Pull the panel out from the profile

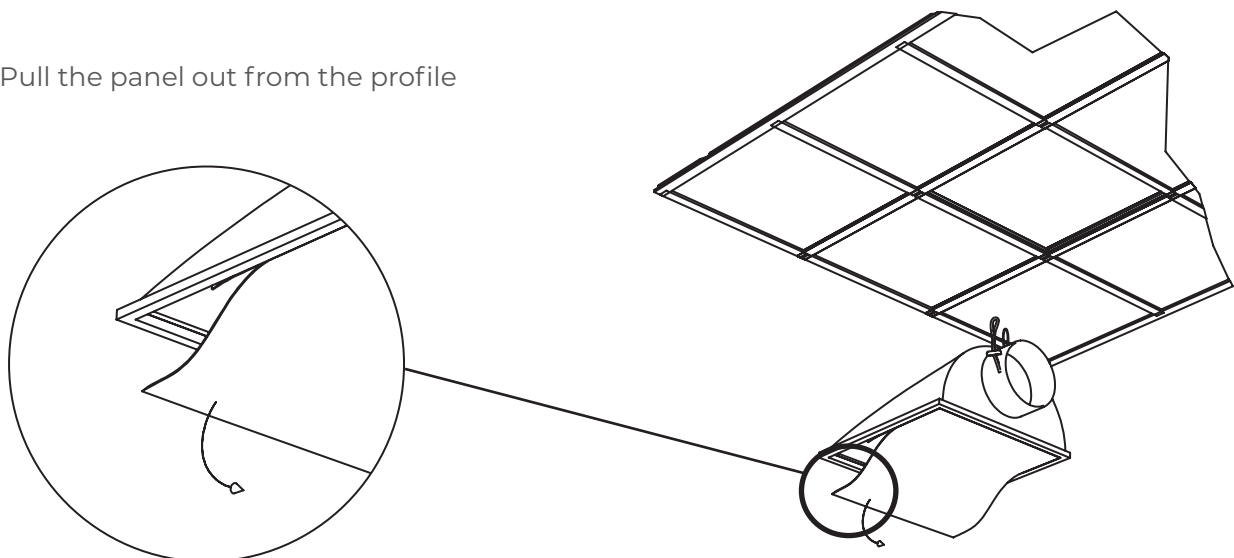

Connecting to solid ducts

Ø 5 in - 10 in

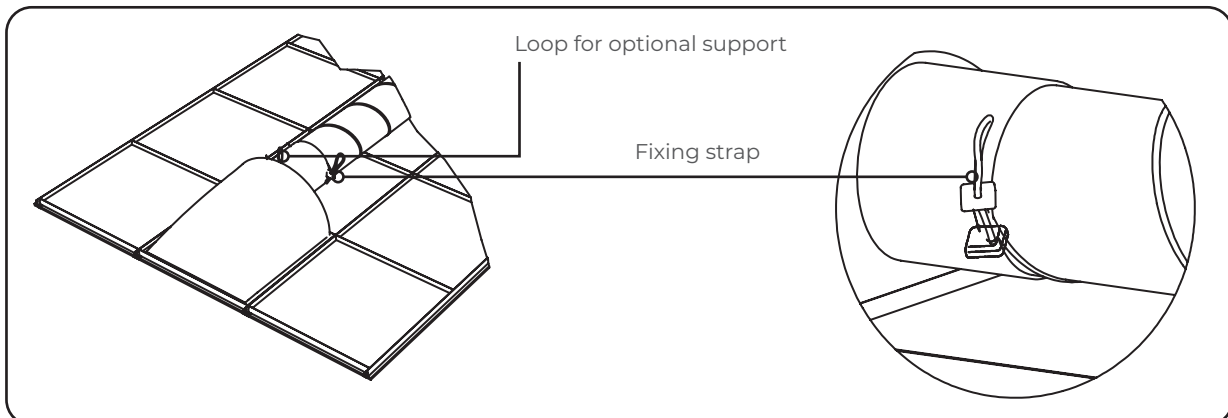

Recommended

Aligned

Tolerance for SMI (only)

Unit	Duct placement	X	Y	Z
SMI	Recommended	Aligned	6 in (Ø < 10 in)	centred
			7 in (Ø = 10 in)	
	Tolerance	-2 in (max)	Recommended ± 2 in	
EPI	Recommended	Aligned	6 in (Ø < 10 in)	centred
			7 in (Ø = 10 in)	

Dimensions

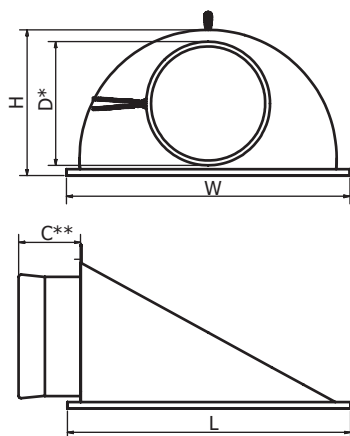

SMI EPI	Size (in)	W (in)	L (in)	H (in)	D* (in)	C** (in)	m (lbs)
	24" x 24"	23 ¾	23 ¾	12	10 ¼	8	4.0
	24" x 48"	23 ¾	47 ¾	12	10 ¼	8	6.4
	48" x 24"	47 ¾	23 ¾	12	10 ¼	8	6.4

* Fits for duct sizes Ø5 -10 in by adjusting the strap lock.

** Length of the connection sleeve when fully extended. Length decreases with the size of the duct when connected. Smaller duct diameter results in a shorter length of the connection sleeve.

Connecting to flexible ducts

Ø 5 in - 10 in

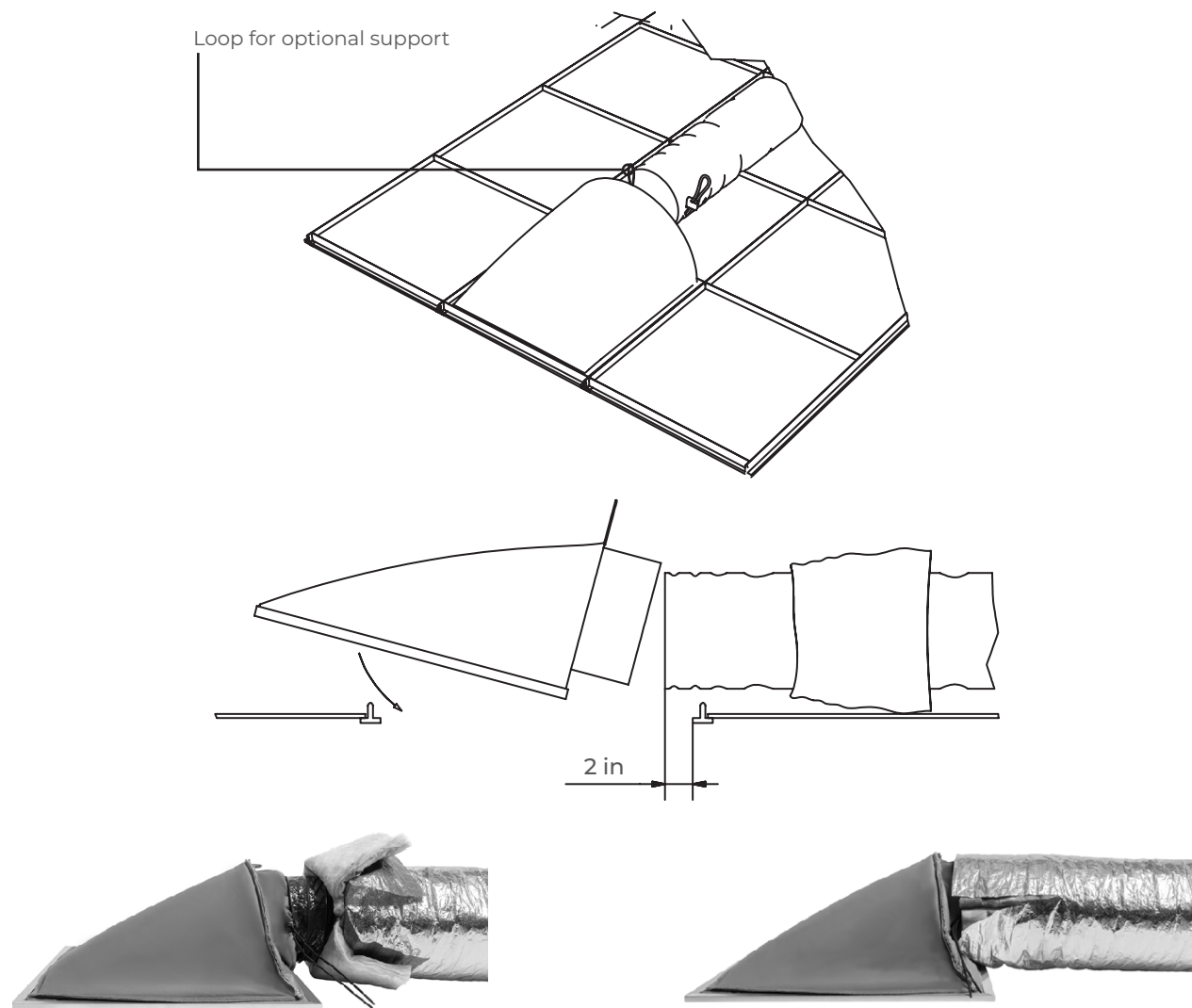

Dimensions

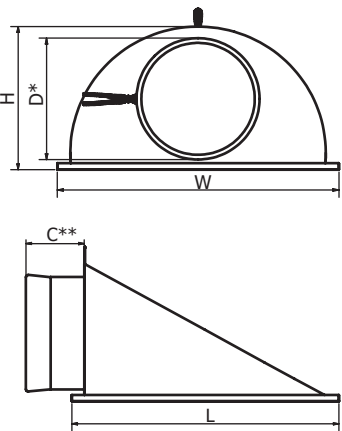

SMI EPI	Size (in)	W (in)	L (in)	H (in)	D* (in)	C** (in)	m (lbs)
	24" x 24"	23 ¾	23 ¾	12	10 ¾	4 ¾	4.0
	24" x 48"	23 ¾	47 ¾	12	10 ¾	4 ¾	6.4
	48" x 24"	47 ¾	23 ¾	12	10 ¾	4 ¾	6.4

* Fits for duct sizes Ø5 - 10 in by adjusting the strap lock.

** Length of the connection sleeve when fully extended. Length decreases with the size of the duct when connected. Smaller duct diameter results in a shorter length of the connection sleeve.